



**VALUING  
NATURE**

# Valuing Nature Annual Conference 2019

**28 & 29 October 2019**

**The Royal Society 6-9 Carlton House Terrace London SW1Y 5AG**



**#ValNat19**

# Welcome...

## ...to the Valuing Nature Annual Conference 2019!

Once again this year, we had an overwhelming number of applications to present the excellent research that is taking place all around the UK and beyond. Being the final Valuing Nature Conference, we decided to shine a spotlight on the seven VN projects:

### Human Health & Wellbeing

- CoastWEB: Valuing the contribution which COASTal habitats make to human health & WellBeing
- IWUN - Improving Wellbeing through Urban Nature
- GHIA - Green Infrastructure to Promote Health and Wellbeing in an Ageing Population
- WetlandLIFE - managing mosquitos and the socio-ecological value of wetlands for wellbeing

### Tipping Points

- Identifying potential tipping points in the benefits derived from the UK's land ecosystems
- Understanding ecosystem stocks and tipping points in UK blanket peatlands
- TPAL - Mechanisms and consequences of tipping points in lowland agricultural landscapes

Delegates will have an opportunity to learn about the outputs and outcomes of these projects, and engage with the researchers through discussion sessions. However, thanks to the variety of high-quality submissions, we have been able to put together a number of interesting and engaging sessions – from the arts and humanities dimension on valuing nature, to the role of finance in nature, and the perspectives from policy and governance. There are a wide range of very interesting presentations under sessions on landscape planning and management, connecting people to nature, and a session dedicated to the health and wellbeing of young people – a pertinent one in light of the role young people are playing in making us sit up and think about our actions in relation to our planet. The posters this year are also as varied and interesting, and we encourage you to take time to view them and have a chat with the researchers during the dedicated poster sessions. To further engage your creative side, and get a glimpse of your area of work from a different angle, we hope you will be quick to sign up on Day 1 for the Theatre Workshop (more information can be found in the following pages).

This year we have opted to take a look back and use that to mark a path forward for the Valuing Nature community. We are pleased to welcome our Keynote Speaker, Professor David Raffaelli, to take us through a retrospective look at how this community of practice has evolved, with his presentation “The long road to London 2019”. This will be followed by our Chairperson, Prof Rosie Hails, who will reflect on the six ways in which the academic, social and political landscape around Valuing Nature has changed since 2013. Prof Sir Charles Godfray will then enlighten us on how Valuing Nature research is challenging and influencing policy development. The final session will be a time to recap but also for delegates to engage on the next steps for this area.

We invite you to share your own experience and participate in the conversations throughout the conference, we also invite you to join in on Twitter [#ValNat2019](#).

Thank you to our funders and everyone who has helped organise, deliver and participate in this conference.

**Sunita Sarkar and Bill Bealey – Centre for Ecology & Hydrology**

**On behalf of the Valuing Nature Programme Coordination Team: Rosie Hails, Guy Duke, Jonathan Porter, Ece Ozdemiroglu, Rob Fish, Michael Winter, Charles Godfray, Heather Trevis and Val Woods**

*The Valuing Nature Programme is a 5 year £7M research programme which aims to improve understanding of the value of nature both in economic and non-economic terms, and improve the use of these valuations in decision making. It funds interdisciplinary research and builds links between researchers and people who make decisions that affect nature in business, policy-making and in practice. The Valuing Nature Programme is funded by the Natural Environment Research Council, the Economic and Social Research Council, the Biotechnology and Biological Sciences Research Council, the Arts and Humanities Research Council, and the Department for Environment, Food and Rural Affairs.*

## Useful Information

### Venue

The Royal Society is located close between Trafalgar Square and St. James's Park on 6 – 9 Carlton House Terrace, London, SW1Y 5AG.

The conference takes place throughout the ground floor, starting in the Wellcome Trust Lecture Theatre, with sessions also being held in 3 rooms on the first floor. A map of the venue can be found at the end of this document.

The venue operates a non-smoking policy throughout the building, on the terrace and forecourt.

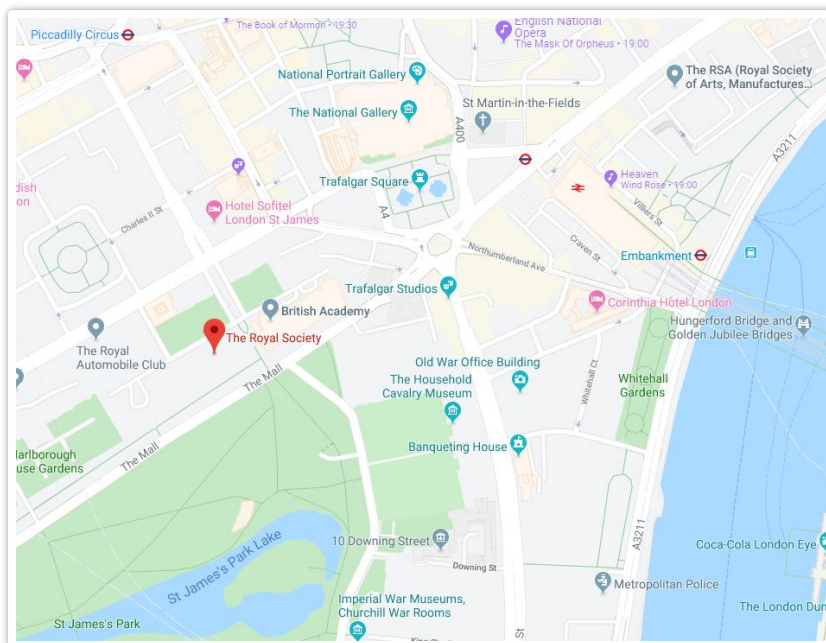

### Transport

**Nearest Underground stations:** Charing Cross and Piccadilly Circus

**Bus routes:** 12, 13, 15 and 453.

**Coach station:** Connections from Victoria coach station

**Car and coach parking:** The Royal Society is located within the congestion charge zone. On-street parking on Carlton House Terrace and Waterloo Place is available for up to four hours and Westminster City Council's Trafalgar Square car park is also close by.

**Bicycle parking:** There are cycle racks along Carlton House Terrace on either side of the Duke of York monument.

### Accessibility

There are four steps from street level to the doorway. There is a wheelchair lift at the entrance which is operable by Reception staff. Please use the buzzer to the right of the entrance steps. The venue is fully accessible.

### Medical Advice

For First Aid assistance please dial 8888.

In the UK non-emergency medical attention can be sought by calling 111, the NHS helpline. If you have an emergency, call 999.

The nearest Accident & Emergency Unit (A&E) is at St Thomas' Hospital, Lambeth, London SE1 7EQ.

### Fire Alarm

In the event of a fire alarm sounding (a continuous alarm), please vacate the building via the marked nearest fire exit sign (please note that may be behind you). Do not stop to collect your belongings, do not use lifts, and do not re-enter the building until authorised.

## Day 1 - Monday 28 October

11:30	Registration opens	Foyer
12:00	Lunch	City of London 1, 2, 3
13:05	Session A	Wellcome Trust Lecture Hall
13:05	Welcome to the Valuing Nature Annual Conference 2019 – <i>Professor Rosie Hails</i>	
13:15	The Long Road to London 2019 – <i>Professor Dave Raffaelli</i>	
13:40	Valuing Nature and the Changing Landscape: A reflection on the six ways in which the academic, social and political landscape around Valuing Nature has changed since 2013 – <i>Professor Rosie Hails</i>	
13:50	Valuing Nature and Valuing Everything Else: Challenges for the UK in a Post-CAP Policy Environment – <i>Professor Sir Charles Godfray</i>	
14:15	Navigating the Conference – <i>Professor Rosie Hails</i>	
14:25	Session B	Wellcome Trust Lecture Hall
	A Tour of the Key Outputs and Outcomes of the Seven Valuing Nature Projects on Health and Wellbeing and Tipping Points.	
	A short introduction to the Landscape Decisions Programme – <i>Professor Heiko Baltzer</i>	
15:30	Tea / Coffee ( <i>Sign up for Theatre Workshop at Registration Desk</i> )	City of London 1, 2, 3
16:00	Session C	Parallel Sessions
	C1: Valuing Nature in Changing Ecosystems	Wolfson Room 1
	C2: Contributions of Urban Nature to Health and Wellbeing	Wellcome Trust Lecture Hall
	C3: Demystifying Tipping Points	Wolfson Room 2
	C4: The VN Cinema	The Kohn Centre
17:30	Session D	
17:30	Poster and Exhibits Session 1	City of London rooms, Marble Hall
17:45	Theatre Workshop ( <i>Limited spaces available</i> )	The Kohn Centre
18:00	Announcements of 'What's New in Research'	Marble Hall's Juliette Balcony
19:00	Light Dinner and networking ( <i>cash bar</i> )	City of London rooms, Marble Hall



## Day 2 - Tuesday 29 October

09:00	Tea/Coffee	City of London 1, 2, 3
09:15	Session E	Wellcome Trust Lecture Hall
	Shaping the Future of Interdisciplinary Research – An Interactive Session	
10:00	Session F	<i>Parallel Sessions</i>
	F1: Arts and Humanities Dimensions of Valuing Nature	Wolfson Room 1
	F2: Linking Natural Capital, Tipping Points and Ecosystem Services	Wellcome Trust Lecture Hall
	F3: Finance for Nature	Conference Room
	F4: From Countryside to Coast – Planning the Landscape	Wolfson Room 2
	F5: Nature and the Wellbeing of Young People	The Kohn Centre
11:15	Tea / Coffee	City of London 1, 2, 3
11:30	Session G	City of London rooms, Marble Hall
	Poster and Exhibits Session 2	
12:00	Session H	<i>Parallel Sessions</i>
	H1: Tools and Methods for Applying the Benefits of Urban Nature	Wolfson Room 2
	H2: Connecting People to Nature	Wolfson Room 1
	H3: Valuing Nature in Policy and Governance	Wellcome Trust Lecture Hall
	H4: The VN Cinema	The Kohn Centre
13:15	Lunch	City of London 1, 2, 3
14:45	Session I	Wellcome Trust Lecture Hall
	What Did the Valuing Nature Programme Do for Us?	
16:15	Close and Refreshments	City of London 1, 2, 3

## Day 1 - Monday 28 October

11:30	<b>Registration opens</b>	<b>Foyer</b>
12:00	<b>Lunch</b>	<b>City of London 1, 2, 3</b>
13:05	<b>Session A</b>	<b>Wellcome Trust Lecture Hall</b>
13:05	<b>Welcome to the Valuing Nature Annual Conference 2019</b> <i>Professor Rosie Hails, National Trust, Valuing Nature Programme Coordination Team</i>  Rosie was the Science Director for Biodiversity and Ecosystem Science at the Centre for Ecology & Hydrology until 2018, when she moved to the National Trust to become their first Nature & Science Director. She is the chairperson of the VN Programme Coordination Team.	
13:15	<b>The Long Road to London 2019</b> <i>Professor Dave Raffaelli</i> <i>Woodmeadow Trust &amp; University of York</i>  Dave was Professor of Environmental Science at University of York, and Directed NERC's UKPopNet and then Biodiversity, Ecosystem Services and Sustainability (BESS) programme till he retired in 2017. Since then he has been actively involved with a major conservation initiative at Three Hagges Woodmeadow near York, where he has been able to return to his roots as an entomologist and natural historian. He has been very much involved with the development of the valuing nature agenda in the UK over the past 10 years and served as Chair of the Valuing Nature Programme Advisory Group for several years.	
13:40	<b>Valuing Nature and the Changing Landscape: A reflection on the six ways in which the academic, social and political landscape around Valuing Nature has changed since 2013</b> <i>Prof Rosie Hails, National Trust &amp; Valuing Nature Programme Coordination Team</i>	
13:50	<b>Valuing Nature and Valuing Everything Else: Challenges for the UK in a Post-CAP Policy Environment</b> <i>Professor Sir Charles Godfray</i> <i>Oxford Martin School, Oxford University &amp; Valuing Nature Programme Coordination Team</i>  Charles is a population biologist with broad interests in science and the interplay of science and policy. He has spent his career at Oxford University and Imperial College and is currently Director of the Oxford Martin School and Professor of Population Biology at Oxford. His research has involved experimental and theoretical studies in population and community ecology, epidemiology and evolutionary biology. He is particularly interested in food security and chaired the UK Government Office of Science's Foresight project on the Future of Food and Farming and is currently chair of Defra's Science Advisory Council.	
14.15	<b>Navigating the Conference</b> <i>Prof Rosie Hails, National Trust &amp; Valuing Nature Programme Coordination Team</i>	

### **A Tour of the Key Outputs and Outcomes of the Seven Valuing Nature Projects on Health and Wellbeing, and Tipping Points (1 h)**

A sequential presentation of the aims, key outputs and outcomes from the seven Valuing Nature Projects, followed by a question and answer session with the audience

*Chair: Dr Rob Fish, University of Kent & Valuing Nature Programme Coordination Team*

#### **Understanding ecosystem stocks and tipping points in UK blanket peatlands**

*Mark Reed, University of Newcastle (Presenter: Laurence Jones, Centre for Ecology & Hydrology)*

#### **TPAL - Mechanisms and consequences of tipping points in lowland agricultural landscapes**

*Adrian Newton, University of Bournemouth (Presenter: Lucy Ridding, Centre for Ecology & Hydrology)*

#### **Identifying potential tipping points in the benefits derived from the UK's land ecosystems**

*Tim Lenton, University of Exeter*

#### **GHIA - Green Infrastructure to Promote Health and Wellbeing in an Ageing Population**

*Sarah Lindley, University of Manchester*

#### **IWUN - Improving Wellbeing through Urban Nature**

*Anna Jorgensen, University of Sheffield*

#### **WetlandLIFE - Managing mosquitos and the socio-ecological value of wetlands for wellbeing**

*Tim Acott, University of Greenwich*

#### **CoastWEB - Valuing the contribution which COASTal habitats make to human health & WELLBeing**

*Nicola Beaumont, Plymouth Marine Laboratory*

### **Landscape Decisions: Towards a new framework for using land assets (10 min)**

*Prof Heiko Baltzer, Centre for Landscape and Climate Research, University of Leicester & Landscape Decisions Programme Coordination Team*

A short introduction to the new programme which will be addressing the challenge of delivering better, evidence-based decisions within UK landscapes through research collaboration with policy, business and land management partners to deliver an interdisciplinary decision-making framework to inform how land is used.

**C1: Valuing Nature in Changing Ecosystems****Wolfson Room 1**

WetlandLIFE and CoastWEB are two Valuing Nature projects funded through the Health and Wellbeing programme. The six presentations (three from each project) in this session reflect the interdisciplinary approaches to valuing saltmarsh (in Wales) and wetlands (in England) both projects have taken. Reporting on diverse perspectives from economic analysis, place-based narratives, intangible cultural values, conceptual frameworks, psychological perspectives and understanding the ecology of mosquitoes, the sessions provide a rich insight into the importance of using diverse lenses to understand coastal and wetland values for health and wellbeing.

*Co-Chairs: Dr Nicola Beaumont, Plymouth Marine Laboratory and Dr Tim Acott, University of Greenwich*

**A framework linking ecosystem services and human well-being: an application to saltmarsh**

*Olivia Rendon, Plymouth Marine Laboratory (CoastWEB)*

**Psychological restoration potential of coastal environments: a photo-rating study**

*Elizabeth (Lizzi) Gabe-Thomas, Plymouth Marine Laboratory (CoastWEB)*

**"I want to show you something about the saltmarsh": exploring intangible values for wellbeing as part of the CoastWEB project**

*Karen Henwood, Cardiff University (CoastWEB)*

**Placed Based Narratives and Contemporary Social Representations of English Wetlands**

*Mary Gearey, University of Brighton (WetlandLIFE)*

**'English wetlands and mosquitoes: economic values, scenarios and risks?'**

*Joe Morris, Cranfield University (WetlandLIFE)*

**How can wetland creation and restoration be managed without risking nuisance and disease from mosquitoes?**

*Frances Hawkes, University of Greenwich (WetlandLIFE)*

**C2: Contributions of Urban Nature to Health and Wellbeing****Wellcome Trust Lecture Hall**

Human Health and Wellbeing projects GHIA and IWUN have both studied the value of nature and greenspaces on urban populations. The GHIA research project - 'Green Infrastructure and the Health and Wellbeing Influences on an Ageing Population' researched the benefits and values of urban GI for older people and how GI and specific interventions can be best used to support healthy ageing in urban areas. IWUN – 'Improving Wellbeing through Urban Nature' explored the relationships between urban natural environments and health and wellbeing across the whole of Sheffield, and how urban residents communicate their own stories and values relating to their connectedness with nature. In this session six project researchers (three from each project) will present and reflect on their findings.

*Chair: Dr Sarah Lindley, University of Manchester*

**Green infrastructure and the Health and wellbeing Influences on an Ageing population – headline findings**

*Sarah Lindley, University of Manchester (GHIA)*



---

**Reconnect dementia walks to nature**

*Philip James, University of Salford (GHIA)*

**To what extent might green infrastructure help to moderate ultra-fine particle concentrations in urban areas?**

*Matt Dennis, University of Manchester (GHIA)*

**Natural environments, health and wellbeing in Sheffield: population level associations**

*Anna Jorgensen, University of Sheffield (IWUN)*

**Identifying healthy green space interventions that work? Our tale of lists, valuations and barriers**

*Nicola Dempsey, University of Sheffield (IWUN)*

**The practice of everyday (wild)life**

*Julian Dobson, University of Sheffield (IWUN)*

---

**C3: Demystifying Tipping Points****Wolfson Room 2**

There is increasing concern that environmental change can lead to rapid changes in ecosystems, which may lead to thresholds or tipping points in provision of benefits to people. This session will examine recent evidence regarding these phenomena, specifically in relation to the dynamics of natural capital and ecosystem services. Presentations will profile the results of three research projects undertaken as part of the Valuing Nature Programme, plus other related research initiatives.

*Chair: Professor Tim Lenton, University of Exeter*

**Demystifying Tipping Points**

*Guy Duke, GD NatCap Ltd & Valuing Nature Programme Coordination Team*

**Tipping points in lowland agricultural landscapes**

*Stephen Watson, University of Portsmouth (TPAL)*

**Reconstructing land use change using historical data**

*Lucy Ridding, Centre for Ecology & Hydrology (TPAL)*

**Deriving dose response functions to help link ecological and economic approaches in peatlands**

*Laurence Jones, Centre for Ecology & Hydrology (Peatlands Tipping Points)*

**VNP Peatland Tipping Points project: social, economic and cultural aspects**

*Jasper Kenter, University of York (Peatlands Tipping Points)*

**Numerous abrupt changes in Great Britain vegetation carbon projected under climate change**

*Chris Boulton, University of Exeter (UK Ecosystem Benefits' Tipping Points)*

**Abrupt shifts in national land use and food production after a climate tipping point**

*Paul Ritchie, University of Exeter (UK Ecosystem Benefits' Tipping Points)*

---

**C4: The VN Cinema****The Kohn Centre**

Sit back and immerse yourself in short videos from a variety of projects in the area of valuing nature. The videos will be playing in a loop during this session

**Immersed in Nature: a literature review of Virtual/Augmented Reality apps (5min)**

*Kirk Woolford, Rougher Cut Productions*

**People Enjoying Nature (PEN): supported visits in the Pendle Hill landscape for people dealing with mental health and social isolation issues (4min)**

*Cathy Hopley, Pendle Hill Landscape Partnership*

---

---

**Inspiring The Next Generation (4min)**

Toos van Noordwijk, Earthwatch

**Improving Wellbeing through Urban Nature (4min 50s)**

Anna Jorgensen, University of Sheffield (IWUN)

**Valuing Nature - Environmental Economics (11min 21s)** Dawn Scott, University of Exeter

---

**17.30 Session D****Poster Session 1****City of London rooms, Marble Hall**

Over 30 posters are on display during the conference. The first of two poster sessions', allowing delegates and presenters to engage extensively. A list of poster titles and lead authors is provided below.

\*If you are presenting a poster please put it up by 17.00 and use the poster board that corresponds to the number your poster has been assigned in the list below.

---

**The Word Hide****City of London 1**

Inspired by manmade structures in nature, particularly the bird-hide, the WetlandLIFE Word Hide uses text and texture to consider how language and narrative shape our perception of the natural world. Part of the Hide & Seek Project, which reframes conventional bird-hides as story repositories, the WetlandLIFE Word Hide is an interactive space designed to encourage observation, reflection and creativity in thinking about the interconnection of nature and narrative.

To learn more about the Hide & Seek storytelling network please visit [www.wetlandlife.org/hide-seek](http://www.wetlandlife.org/hide-seek)

---

**The Valuing Nature Stand****City of London 2**

Pick up copies of our latest reports and documents, and engage with the VN PCT

**The Landscape Decision Programme Stand****City of London 1**

Come and engage with members of this new programme

---

**17:45 Theatre Workshop: Nature in Action****The Kohn Centre**

*Sign up from 15:30 at the registration desk – participation limited to 20 delegates*

**Arts-led workshop to communicate the values of nature**

*Lead: Alexandra Bond Burnett, Bond Ambition*

This 60-minute workshop will use performance techniques used by actors to cultivate an empathetic approach to communication. Participants will discover how theatrical work helps build relationships and connections with the emotions behind the value of nature in research, policy and practice. Game playing will be used to create scenes, resulting in a new perspective of your field of study.

---

**18:00 Announcements of 'What's New in Research'****Marble Hall's Juliette Balcony**

---

Those interested in sharing their new research have the chance to shout-it out from the balcony overlooking the Marble Hall. An informal way to let people know what is new and exciting in your area, whilst sipping on some complimentary drinks.

A host of new Demystifying Papers, a hallmark of the VN programme, are going to be announced during this time, including Cost Benefits Analysis, Green Finance, Valuing Arts and Arts Research, Shared and Social Values, and Health Metrics.

Copies of most of the reports will be available at the VN stand in City of London 2

19:00

**Light Dinner and networking (cash bar)**

**City of London 1, 2, 3, Marble Hall**

## Day 2 -Tuesday 29 October

09:00	Tea/ Coffee	City of London 1, 2, 3
09:15	Session E	Wellcome Trust Lecture Hall

### Shaping the Future of Interdisciplinary Research – An Interactive Session

The Valuing Nature Program has established extensive interdisciplinary partnerships with the aim of improving our understanding of the value of nature and the use of these values in decision making. This interactive session is an opportunity to share your perceptions, opinions and experiences of interdisciplinary approaches, leading on to a joint exploration of potential futures for interdisciplinary research.

*Lead: Dr Nicola Beaumont, Plymouth Marine Laboratory, with Ece Ozdemiroglu, eftec & Valuing Nature Programme Coordination Team, and Jonathan Porter, Countryside & Valuing Nature Programme Coordination Team*

10:00	Session F	Parallel Sessions
-------	-----------	-------------------

### F1: Arts and Humanities Dimensions of Valuing Nature

Wolfson Room 1

With the development of interdisciplinary approaches to valuing nature, artists and arts practitioners can bring contrasting approaches to valuing nature beyond other forms of valuation, like ecosystem services and economics. This session provides an opportunity to engage critically with salient examples of arts-led and arts-informed research focussing on the relationships between art and the value of nature.

*Chair: Rob Fish, University of Kent & Valuing Nature Programme Coordination Team*

#### **A Room with A View: Observing nature and narrative through the bird hide**

*Victoria Leslie*

#### **The poetics of the science of place**

*Simon Read, Middlesex University London*

#### **Photoria: exploring the values of fireflies through immersive narrative**

*Kirk Woolford, Rougher Cut Productions*

#### **Spiritual place-making in urban landscapes**

*Christopher Ives, University of Nottingham*

#### **The funeral march of economic valuation**

*Chris Fremantle, Gray's School of Art*

### F2: Linking Natural Capital, Tipping Points and Ecosystem Services **Wellcome Trust Lecture Hall**

Climate change and land use policy responses to Brexit and the Paris Agreement may lead to unexpected and abrupt changes in the delivery of crucial ecosystem services. This panel discussion will give delegates an opportunity to reflect on the risks posed by a number of potential tipping points in natural capital and ecosystem services, and what we can do to avoid or mitigate those risks. Each of the Valuing Nature Programme Tipping Points projects will start the session with a provocative question linked to a tipping point

they have researched, and delegates will be invited to ask their own questions and debate with panellists from academia and Government.

*Chair: Dr Mark Reed, University of Newcastle*

**Panel:**

*David Stone - Deputy Chief Scientist, Natural England*

*Alastair Johnson - Head of Natural Environmental Economics, Defra*

*Emily Finney - Head of Natural Resources Policy, Welsh Government*

*Steve Arnold - Economist, Environment Agency*

*Researchers from the Tipping Points projects*

---

**F3: Finance for Nature**

**Conference Room**

There is a growing interest in the finance and investment community to understand nature better. There is also a growing interest in the Valuing Nature Network to learn more about finance and investment. Picking up on a recent UKRI / Valuing Nature Programme report on Research and Innovation needs of the insurance / financial services sector relating to measuring and valuing nature, and launching the Demystifying Green Finance paper, this session brings together representatives from local and central government; private investment and investment analysis to share their experience in bridging this gap and help make better 'business cases' for green investment.

*Co-Chairs: Guy Duke, GD NatCap Ltd & Valuing Nature Programme Coordination Team and Ece Ozdemiroglu, eftec & Valuing Nature Programme Coordination Team*

**Introduction from Guy Duke followed by presentations from:**

*Dan Barwick, Programme Manager Green Finance, Defra - a UK government perspective*

*Krista Patrick, Natural Capital Coordinator, Greater Manchester Combined Authority - a local government perspective*

*Jim Totty, Managing Director, Earth Capital - an investor perspective*

*Steven Bullock, Global Head of Research, Trucost (part of S&P Global) - perspective from an investment analyst*

**Q&A**

---

**F4: From Countryside to Coast - Planning the Landscape**

**Wolfson Room 2**

This session explores the tools, methodologies and the barriers for managing our land from countryside to coast. How can policy be integrated better and what knowledge do land planners need for improving their decision making? To answer these questions this session will share experiences across key land use areas in the UK from agriculture, forestry, coastline and the urban environment.

*Chair: Patrick Begg, National Trust*

**Mapping natural capital in the Oxfordshire growth area**

*Alison Smith, University of Oxford*

**Barriers & enablers to aligning policy agendas – the case of Flood & Coastal Erosion Risk Management in Wales**

*Meghan Alexander, University of East Anglia*



**Natural Capital catchment register and accounts – trialling a natural capital approach within the environmental planning cycle**

*Kathrynne Moore, Environment Agency*

**Sustainable intensification in a post-Brexit landscape**

*Richard Gunton, University of Winchester*

**Future forests and ecosystem services: from theory to practice**

*Eleanor Tew, University of Cambridge, Forestry England*

---

**F5: Nature and the Wellbeing of Young People**

**The Kohn Centre**

Greenspace exposure has been shown to have mental health benefits for young people. In urban settings, the effects of greenspace exposure on the well-being of young people may be moderated by noise and air quality, but also the social environment. Research over the past 10 years has developed at a very fast pace and the recent research has started to pay close attention to the mechanisms that may explain such effects on young people. In this session we present some of the recent UK research that explores these mechanisms.

*Chair: Professor Eirini Flouri, University College London*

**The Role of Greenspace in Children’s Reward and Punishment Sensitivity**

*Eirini Flouri, University College London*

**The role of the physical environment in adolescent mental health**

*Marie Mueller, University College London*

**Tailoring Engagement with Urban Nature for University Students**

*Francesca Boyd, University of Sheffield*

**Out in the Open: An Examination of the Physical and Psychological Affordances of Outdoor Spaces within the delivery of Formal Therapy**

*Victoria White, University of Cumbria*

**Informing investment in the environment for health and wellbeing**

*Sian de Bell, University of Exeter*

---

11:15      **Tea/ Coffee**

**City of London 1, 2, 3**

11:30      **Session G: Poster Session 2 & Exhibits**

**City of London rooms, Marble Hall**

*(See Session D for full details)*

12:00      **Session H**

**Parallel Sessions**

---

**H1: Tools and Methods for Applying the Benefits of Urban Nature**

**Wolfson Room 2**

There is a considerable body of evidence highlighting the multiple benefits of natural environments for urbanites, but this evidence is not being applied at scale in most areas of policy and practice from health and social care to urban development. This session introduces innovative ways of ensuring that the benefits of urban nature are applied across different sectors.

*Chair: Dr Anna Jorgensen, University of Sheffield*

**Green Health Partnerships in Scotland - greening healthcare in Dundee**

*Rebecca Wade & Viola Marx, Abertay University & Dundee City Council/ NHS Tayside Public Health*

---

### **Improving Access to the Natural Environment**

*Angela Hands, Public Health England*

### **The value of Greater Manchester's green infrastructure for addressing community needs**

*Helen Davies, WSP*

### **Accounting for Diversity in the assessment of social and cultural values of urban nature**

*Kathrin Hörschelmann, Institute for Regional Geography Leipzig (IfL)*

### **Exploring the needs, provision and value of GI for older people with the GHIA online tools**

*Gina Cavan, Manchester Metropolitan University*

### **Building with Nature: Creating Liveable and Sustainable Places**

*Gemma Jerome & Katy Read, Building with Nature & Middlemarch Environmental Ltd*

---

## **H2: Connecting People to Nature**

**Wolfson Room 1**

How and why do people connect with nature? Experience from research has shown that nature provides a strong sense of place. This session will examine the relationships between people and nature looking at the experiences of young people with feral spaces, to the role of urban nature and community gardening and our association with the night sky.

*Chair: Dr Anita Weatherby, National Trust*

### **'I'm going to hug the tree' Insights from a youth led intervention designed to facilitate a connection to nature with young people in a low SES area**

*Jenny Hallam & Laurel Gallagher, University of Derby & Urban Wilderness*

### **Differences in nature relatedness, pro-environmental attitudes and pro-environmental behaviours: The role of urban and nature place preferences**

*Stephanie Wilkie, University of Sunderland*

### **The Systemic Impact of Community Gardening Activities on Wellbeing**

*Yvonne Black, University of Hull*

### **Losing the Milky Way**

*Johanna Korndorfer, Friends of the Lake District*

---

## **H3: Valuing Nature in Policy and Governance**

**Wellcome Trust Lecture Hall**

Valuing nature is inherently a political project. Its advocates see it as a means to embed nature values in policy and governance so that environmental protection and enhancement become integral to decision making across government. This session will hear from those at the heart of environmental governance on both the development of current government policy and how the evidential base emerging from Valuing Nature and other research programmes is influencing policy design and evaluation. The key questions are what has been achieved and what remains to be done to put nature at the heart of the policy process?

*Chair: Professor Michael Winter, University of Exeter & Valuing Nature Programme Coordination Team*

### **Short Presentations followed by Panel & Audience discussion:**

#### **Introducing the Demystifying Cost Benefit Analysis report**

*Martin Hurst*

#### **Measuring and Driving progress towards the goals of the 25 Year Environment Plan**

*Robert Bradburne, Defra*

---

---

**The Dasgupta Review on the Economics of Biodiversity**

*Emily McKenzie, HM Treasury*

**Climate change reporting: Assessing outcomes and maximising outputs**

*Brendan Freeman, Committee on Climate Change*

**Implementing the SDGs: using research to explore how top-down goals translate into on-the-ground action**

*Caroline Howe, Imperial College London*

**Decisions, Values and Systems**

*Ruth Waters, Natural England*

**Enabling a Natural Capital Approach: A new Defra on-line resource**

*Colin Smith, Defra*

---

**H4: The VN Cinema**

**The Kohn Centre**

*See Session C4 for full details*

---

**13:15 Lunch**

**City of London 1, 2, 3**

---

**14:45 Session I**

**Wellcome Trust Lecture Hall**

---

**What Did the Valuing Nature Programme Do for Us?**

The final session will celebrate the legacy of the Valuing Nature Programme, and at the same time explore the next set of challenges that lie ahead. Some of our past placement and business school attendees will give perspectives on the conference, and will also give their personal experience of what the Valuing Nature Programme did for them. Our question and answer session will focus on the next set of challenges for researchers, conservation organisations, business and policy makers. Our panel will present some of their short- and long-term challenges, and then take comments, questions and ideas from the audience.

*Chair: Rob Fish, University of Kent & Valuing Nature Programme Coordination Team*

**Conference Feedback from Early Career Researchers****Audience and Panel Discussion**

*Panel members:*

*Jacky Wood (UKRI NERC Futures)*

*Patrick Begg (National Trust)*

*Ruth Waters (Natural England & Dasgupta Review)*

*Anja Liski (Capgemini & VN Placement Programme)*

---

**16:15 Close and Refreshments**

**City of London 1, 2, 3**

---

## Posters

---

- 1. Valuing nature with iSpotnature.org: a citizen science platform for biodiversity**  
*Janice Ansine, The Open University*
  - 2. Incorporating the insurance value of peri-urban ecosystem services into natural hazard policies and insurance products: Insights from Mexico**  
*Dr Rosalind Bark, University of East Anglia*
  - 3. Expanding the role of participatory mapping to assess ecosystem service provision: A case study of natural capital in the Deben Estuary**  
*Dr Daryl Burdon, Daryl Burdon Ltd*
  - 4. Open-data approaches to mapping (& valuation of) ecosystem service provision anywhere in the World, using Co\$tingNature**  
*Dr Sophia Burke, AmbioTEK CIC*
  - 5. The cost of humanity: More positive attitudes towards humanity curtail concern for animals and nature**  
*Dr Wing Yee (VerBon) Cheung, University of Winchester*
  - 6. From urban agriculture to public health in The Global North: A framework**  
*Catalina Cruz-Piedrahita, Imperial College*
  - 7. Ecosystems in conflict - Environmental change impacts on the Colombian páramos**  
*Prof. Terry Dawson, King's College London*
  - 8. Where to locate new energy infrastructure: a natural capital approach**  
*Gemma Delafield, University of Exeter*
  - 9. Treezilla: a platform for mapping and valuing the UK's urban trees**  
*Nadia Dewhurst-Richman, The Open University*
  - 10. Public Perceptions of Flood Management Schemes in the UK**  
*Mikaela D'Souza, University of Nottingham*
  - 11. When screens replace backyards: Strategies to connect electronic-media-oriented young people to nature**  
*Rachael Edwards, University of Waterloo, Canada*
  - 12. Scottish Natural Capital - Ecosystem Service Accounts**  
*Max Engledew, Office for National Statistics*
  - 13. Connecting Children and Young People to Nature**  
*Nicola Estill, Friends of the Lake District*
  - 14. Urban Green and Blue space benefits in cities from four continents: Asia, Latin America, Africa, Europe**  
*Dr David H Fletcher, Centre for Ecology & Hydrology*
  - 15. Reversing the over-use of natural capital in socio-technical systems - what might a stable system look like?**  
*Dr Rachel Freeman, University College London*
  - 16. Valuing geology - Nature's fundamental component**  
*Julie Harrald, The Geology Trusts*
  - 17. Valuing nature through sustainable agriculture: investments in biochar-pigeon pea businesses in Zambia**  
*Dr Pernille Holtedah, Blue Maia*
-

- 
- 18. AECOM's Natural Capital Laboratory: a testbed site where teams can undertake experimental new techniques to quantify, measure and communicate environmental and social change**  
*Campbell Howe, AECOM*
  - 19. How does the type and quality of urban green and blue spaces impact subjective well-being in London?**  
*Sarah Knight, University of York*
  - 20. Quantification of Birch and Bracken encroachment on heathland using airborne hyperspectral imager and Sentinel 2 satellite imagery**  
*Dr Gary Llewellyn, 2Excel geo*
  - 21. Modelling Habitat Quality in Malaysia using Sentinel-2 Deforestation Data and an Ecosystem Model**  
*Valentin Louis, University of Leicester*
  - 22. Landscape Enterprise Networks**  
*Catherine McCosker, 3Keel*
  - 23. Testing a Natural Capital Accounting Approach on SNH Land**  
*Tom McKenna, Scottish Natural Heritage*
  - 24. Modelling erosion and sediment transport to inform Payment for Ecosystem Services schemes**  
*Dr Andrea Momblanch, Cranfield University*
  - 25. Schools Biodiversity Project: Nurturing Nature & Wellbeing**  
*Louise Montgomery, Royal Holloway University of London*
  - 26. Using Sentinel-2 derived deforestation maps of the Primeval Białowieża Forest to map habitat degradation with the InVEST Ecosystem Service Model**  
*Rosalinda Morrone, University of Leicester - Polytechnic of Milan*
  - 27. Using InVEST models combined with Sentinel-2 products to quantify mangrove changes over the Kenyan coast**  
*Silvia Poli, CLCR University of Leicester*
  - 28. Impacts of urban greenspace on mental health**  
*Dr Michaela Roberts, James Hutton Institute*
  - 29. SmartRiver: IoT and Natural Flood Management**  
*Andrew Ross, Global Garden Ltd*
  - 30. Changing Values of Inland Waterways: mapping evolving themes in the assessment - policy 'loop'**  
*Nicki Schiessel Harvey, Birmingham City University*
  - 31. Natural capital approaches for offshore renewable energy**  
*Dr Neda Trifonova, University of Aberdeen*
  - 32. Economic Valuation of Kundapura Mangroves of Udupi, Karnataka, India**  
*P. Vijaya Pandi, NCSCM INDIA*
  - 33. Prescribing Nature in Rural Communities**  
*Ailsa Villegas, NHS Highland*
  - 34. Medmerry Managed Realignment Scheme: An Ecosystem Services Valuation**  
*Claire Wansbury and Warwick Wainwright, Atkins*
  - 35. Assessing the effect of stressors (algal mats and sediment disturbance) on the function and valuation of key coastal ecosystems for improving water quality**  
*Gordon Watson, University of Portsmouth*
-



---

**36. Using marine biotope data to link natural capital with improved water quality outcomes and better decision-making**

*Dr Stephen Watson, University of Portsmouth*

**37. Beyond Green: Rethinking Nature in Urban Public Spaces**

*Ying Li, University of Gloucestershire*

**38. Valuation of wetlands**

*Sharanya Basu Roy, Cranfield University*

**39. Using evidence-based logic chains to develop indicators for impacts of heavy metals on ecosystem services**

*Laurence Jones, Centre for Ecology & Hydrology*

---

## The Valuing Nature Programme Coordination Team



Michael Winter OBE, is Professor of Land Economy and Society in the Centre for Rural Policy Research at the University of Exeter. He is also a board member of Natural England and the UK Joint Nature Conservation Committee.



Rob Fish is a Reader in Human Ecology at the University of Kent. Alongside VNN, he is lead editor of the British Ecological Society Journal [\*People and Nature: a journal of relational thinking\*](#).



Ece Ozdemiroglu is the Founding Director of eftec, which specialises in interpreting economic value evidence for policy and decision making and evaluation. She is a Member of the Committee on Climate Change - Adaptation, a Fellow of the RSA and a steering group member of the Natural Capital Initiative.



Guy Duke is Director of GDNatCap Ltd. He is Business Champion for the Valuing Nature Programme Coordination Team, in which capacity he leads on Business Round Tables, Business Impact Schools and the Business Interest Group. He directs the H2020 project We Value Nature, working to accelerate business uptake of natural capital thinking, and is a CEH Fellow and Honorary Research Associate, Environmental Change Institute, University of Oxford. Previous roles include Deputy Chair JNCC and European Commission lead for EU biodiversity and ecosystem services policy.



Jonathan Porter is a founding director of Countryside, a company which combines the creative skills of a communications agency with the scientific knowledge of an environmental consultancy. Jonathan is President of the UK Region of the International Association for Landscape Ecology and a member of the committee of the European Association for Landscape Ecology. He is a trustee of the Ecosystems Knowledge Network.



Rosie Hails is currently Director of Nature & Science at the National Trust and formerly CEH Science Director for Biodiversity and Ecosystems Service. She is the Chairperson of the Valuing Nature PCT.



Prof Sir Charles Godfray was until recently, the Policy Champion for the VN programme. He has spent his career at Oxford University and Imperial College and is currently Director of the Oxford Martin School and Professor of Population Biology at Oxford. He is particularly interested in food security and chaired the UK Government Office of Science's Foresight project on the Future of Food and Farming and is currently chair of Defra's Science Advisory Council.

## Venue Floor Plan

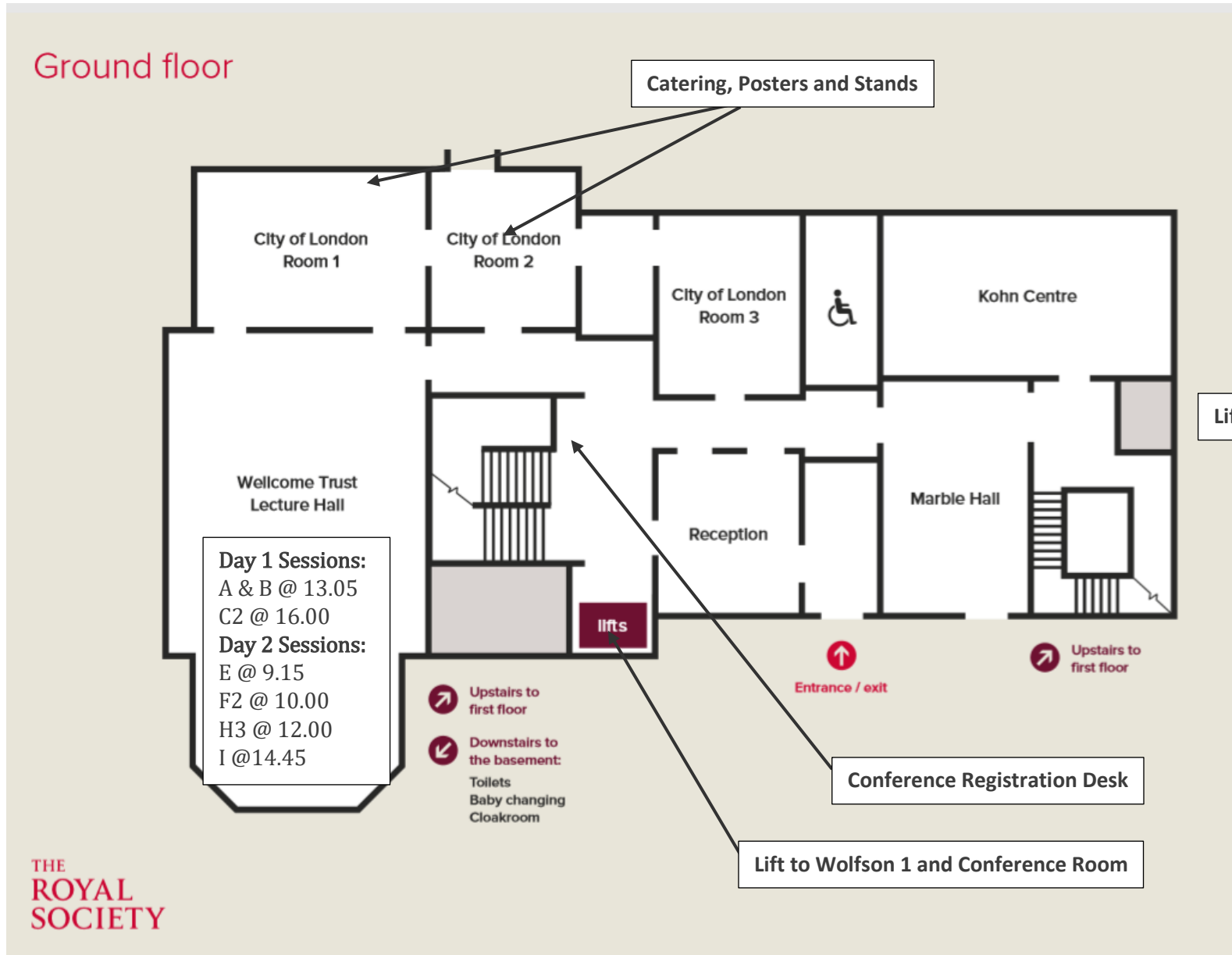





# Marble Hall and Kohn Centre

## Ground floor



SIZE SPECIFICATIONS	LENGTH (M)	WIDTH (M)	AREA (M <sup>2</sup> )
Kohn Centre	9.1	7.6	68.25
Kohn Centre stage	5.7	1.8	–
Marble Hall total	11.6	7.2	77
Area A	4.1	3.7	–

### KEY

-  Plug socket
-  Internet portal
-  CA Catering area
-  Exhibitor stands
-  16 amp comando socket, 415v

### CONTACT INFO

T: +44 20 7451 2612  
 E: [venuehire@royalsociety.org](mailto:venuehire@royalsociety.org)  
[royalsociety.org/venue-hire](http://royalsociety.org/venue-hire)

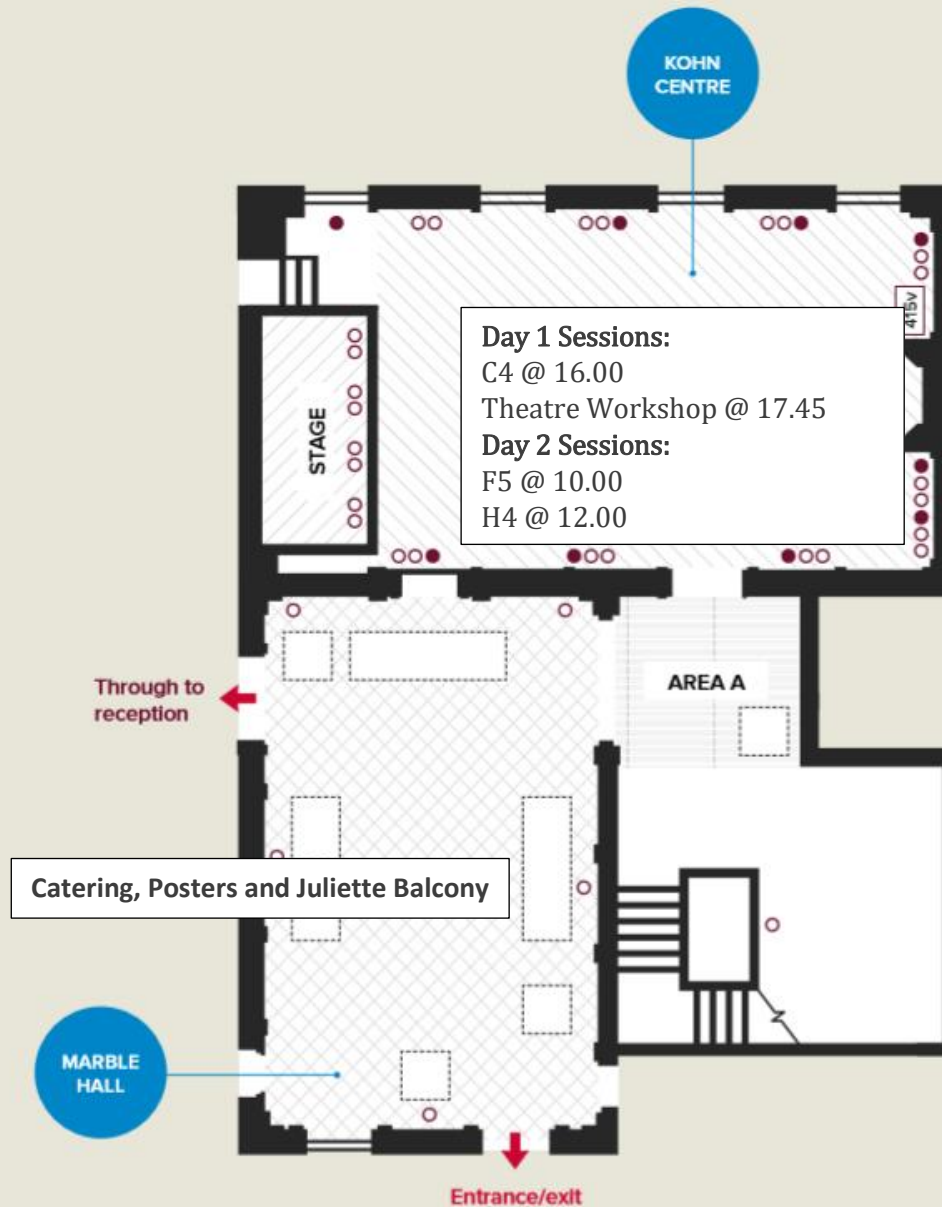

# First floor

